

FOBA studio stands. Universally popular.

**FOBA**<sup>®</sup>  
STUDIO-TECHNOLOGY

## Stability in the studio – even for very demanding professionals

A FOBA studio stand is an essential appliance for every professional photographer with an eye for quality. Studio stands warrant great stableness and a shooting free of wobbling – even when working with big and heavy cameras or sensors. FOBA stands can be adjusted quickly and easily, and locked in place with great accuracy. For the photographer, this means decisive speed of action, top safety conditions, ergonomic handling and maximum efficiency. FOBA studio stands are characterized by highest stability and excellent balance. Vertical and horizontal displacements, supported by 24 state-of-the-art, individually adjustable ball bearings, are particularly smooth and precise. The exceptionally precise mechanical parts and the built-in rulers and gauges, embedded either in the vertical or the horizontal axis, depending on the model, guarantee exact reproducibility of all stand settings.

FOBA studio stands rest and move freely and smoothly on ball-bearing casters. The heavy cast-iron foot can be lifted and lowered without much effort with one central pedal. Once lowered, safety and stable positioning are ensured.

### Three stand types to answer all needs

FOBA offers three studio stands sub ranges, designed to cover all possible photographic requirements. Whether for heavy professional 8x10" cameras with long barrels, mid-size or light-weight passport cameras, FOBA has the right studio stand for it (for a general view go to page 14).

### FOBA studio stands: designed to and for work

FOBA's typical, almost emblematic hexagonal steel pipe has proved to be not only elegant but also functional; it ensures absolute twist-proof adjustment of cameras and appliances.

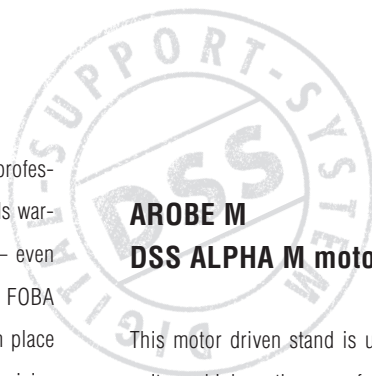

## AROBE M DSS ALPHA M motor driven

This motor driven stand is used when high precision, but not quite as high as the one of an industrial robot is needed. The cabled remote control makes this stand the ideal tool for measuring or shooting in closed or inaccessible quarters. Four 24V motors allow all necessary movements. Based on the AROBE – DSS ALPHA model, it can be equipped with the same accessories.

### DSS ALPHA M: Technical data

#### 4-channel control, including cable 5m

|  |                         |   |
|--|-------------------------|---|
| Horizontal beam displacement:  | 68 cm                   | ← |
| Vertical displacement above floor:   | 60 cm – 240 cm          | ↓ |
| Tilt:  | - 90° – + 30°           | ↗ |
| Pan:   | -180° – + 90°           | ↻ |
| <hr/>  |                         |   |
| Standard floor height:   | 2.85 m                  |   |
| Any other heights on request   |                         |   |
| Weight:  | 228 kg (503 lbs)        |   |
| Power supply:  | 220 V / 24 V max. 140 W |   |
| Load: On request (the number of built-in counterweights depends on the weight of the camera or sensor) |                         |   |

Other characteristics match those of the standard AROBE model. Custom designs available on request.

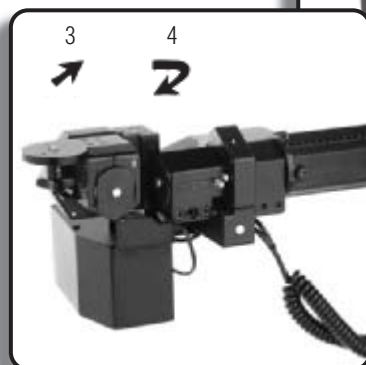
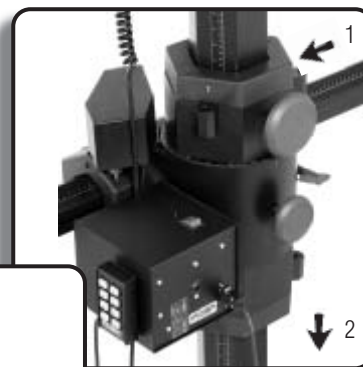
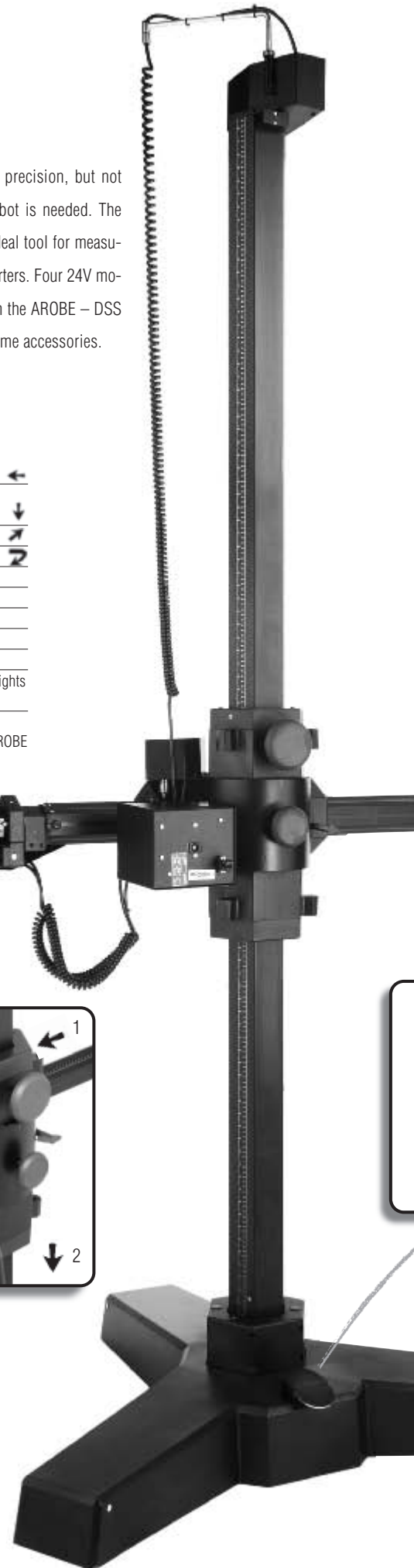

Cabled remote control



Precise rulers and gauges – in millimeters and inches – allow the user to position and to repeat all settings accurately.

FOBA stands are very sturdy, and therefore suitable for very heavy cameras or sensors. The admissible standard load is calculated on the basis of the average camera or sensor weight. It can be increased almost at will by adding extra counterweights inside the shaft. However, each additional counterweight reduces the operational height of the beam by the height of each weight.



Crosspiece and beam owe their smooth movements (crosspiece vertically, beam horizontally) to 24 state-of-the-art ball bearings. Ergonomic handles and locking devices allow float-free blocking of horizontal, vertical and rotation movements.



All rotating elements – supports, arms and uprights – are inserted onto the spigot at the end of the cross beam and can be braced in any position by the clamp. The initial tension can be regulated with the 2 additional hex-socket screws, permitting thus to adjust the friction on the spigot corresponding to the weight of the camera. For better convenience and individual operation, the clamp can be mounted on both sides of the support, arm or upright.



The end of the beam is equipped with a spigot onto which various tilt heads and other rotating accessories can be inserted. Some models have a rotation gauge with which settings can be repeated accurately.

Shaft and beam are manufactured with warp-resistant, hexagonal steel pipes. A camera or sensor can be mounted at each end of the beam.

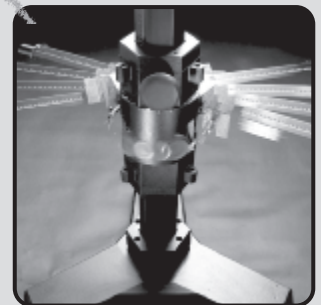
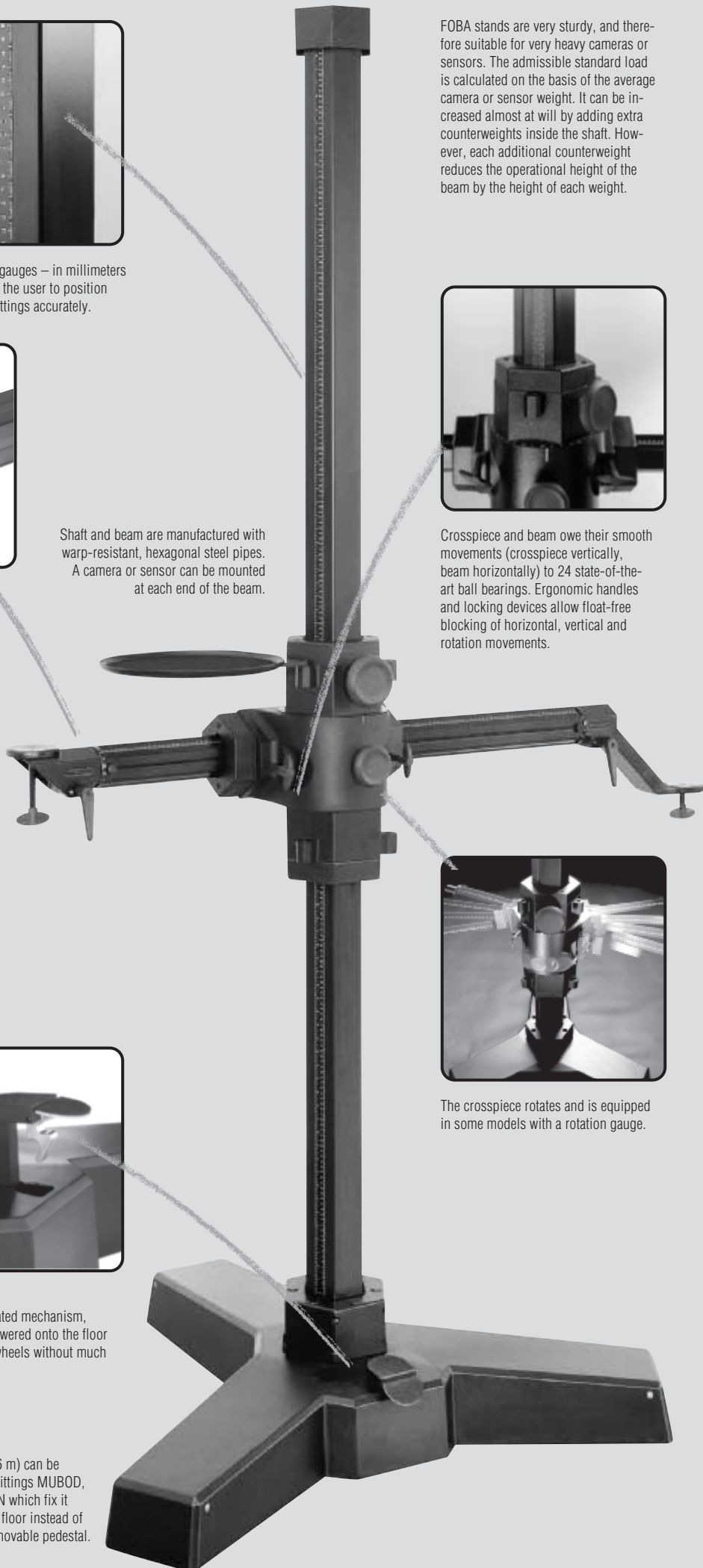

The crosspiece rotates and is equipped in some models with a rotation gauge.



Shock absorber for AROBE and AROBI cast-iron pedestals. The shock absorbing system allows the pedestal to be lifted and lowered without jolts, thus effectively safeguarding highly sensitive equipment such as cameras or laser measuring apparatus.

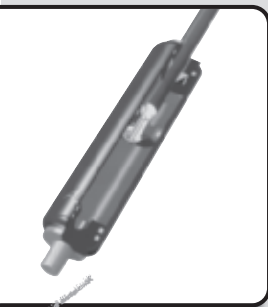

**Double pedal**  
Due to a sophisticated mechanism, the stand can be lowered onto the floor or raised onto its wheels without much effort.

Tall stands (up to 6 m) can be delivered with the fittings MUBOD, MUDEK or MUWAN which fix it permanently to the floor instead of with the standard movable pedestal.

All FOBA components are lacquered in anti-reflex black.

## FOBA DSS studio stands range

### The best a studio can have

FOBA, manufacturing leader of high-quality studio stands, has designed the DSS range to **satisfy extreme requirements and provide even more working safety**. Studio stands that are comfortable to work with, safe and absolutely steady are not only required for large format professional cameras, but also for sensors and digital cameras.

#### Safety

FOBA is aware of the amounts that users entrust to its studio stands in the form of cameras or digital equipment. Consistent accuracy, as well as countless measurement and control processes in production and assembly allow FOBA stands to meet even the narrowest tolerances.

#### Precision

Stability alone is no longer enough – the modern user wants high-precision shaft guiding, adjusting and locking. This is why the FOBA DSS range is equipped with 24 state-of-the-art ball bearings, brakes and locking components are made of extensively tested materials, which ensure fully manageable friction and almost no wear.

#### Digital

Digital photographic equipment demands even more from a studio stand than conventional cameras. FOBA has designed its DIGITAL SUPPORT SYSTEM (DSS) with an eye to the future.

#### Variety

With its large selection of accessories, each FOBA studio stand can cater to the most diverse requirements. Therefore, in the long run, the initial expenditure turns into a worthwhile investment.

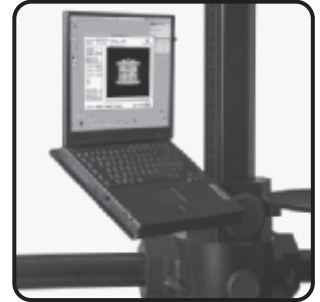
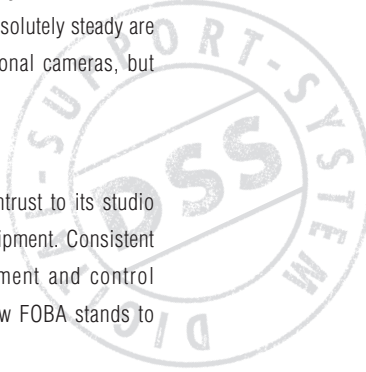

Laptop holder ARTEU, fits any current model.

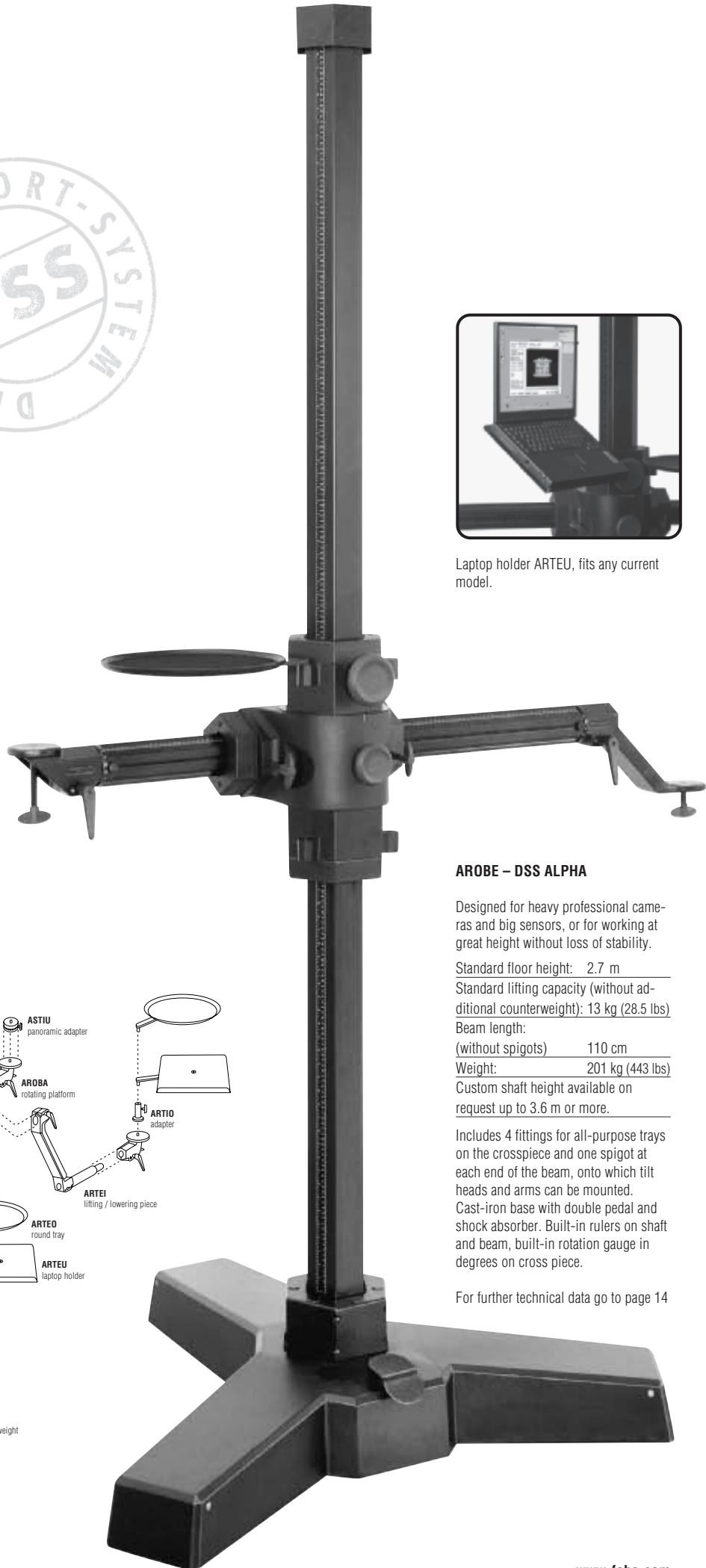

#### AROBÉ – DSS ALPHA

Designed for heavy professional cameras and big sensors, or for working at great height without loss of stability.

|   |                  |
|---|------------------|
| Standard floor height:  | 2.7 m            |
| Standard lifting capacity (without additional counterweight): | 13 kg (28.5 lbs) |
| Beam length:  |                  |
| (without spigots)   | 110 cm           |
| Weight:   | 201 kg (443 lbs) |
| Custom shaft height available on request up to                | 3.6 m or more.   |

Includes 4 fittings for all-purpose trays on the crosspiece and one spigot at each end of the beam, onto which tilt heads and arms can be mounted. Cast-iron base with double pedal and shock absorber. Built-in rulers on shaft and beam, built-in rotation gauge in degrees on cross piece.

For further technical data go to page 14

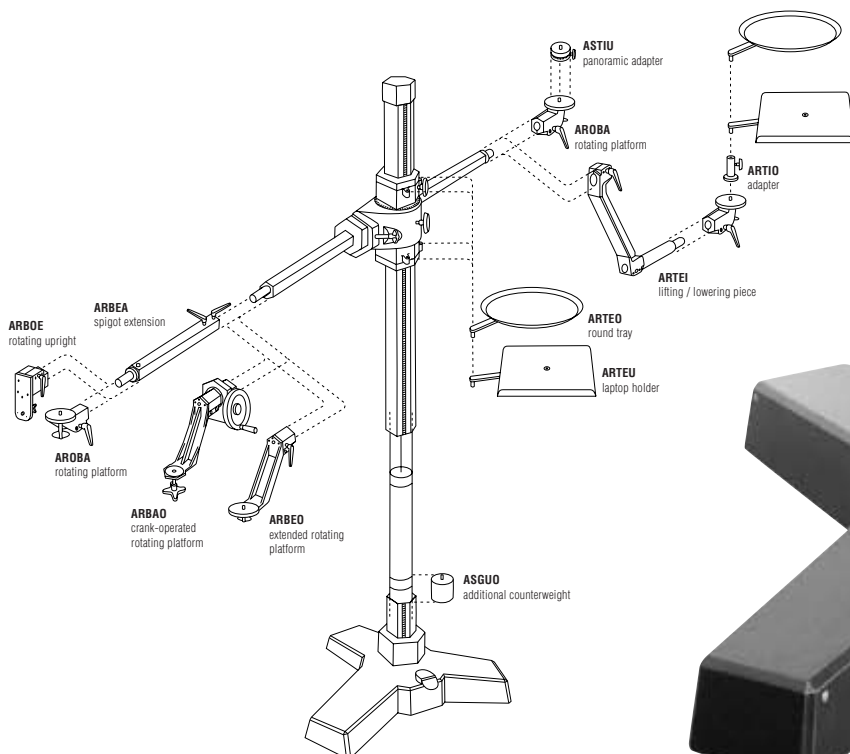

## AROBO – DSS OMEGA

This studio stand fulfils everything that is expected of a stand in the modern studio. It combines many characteristics of DSS ALPHA and of the legendary all-purpose ASABA stand for a very agreeable price.

### Technical data:

|  |                  |
|--|------------------|
| Standard floor height:   | max. 2.85 m      |
| Standard lifting capacity<br>(without additional counterweight): | 11 kg (24 lbs)   |
| Beam length:<br>(without spigots)                                | 110 cm           |
| Weight:  | 128 kg (282 lbs) |

Custom height below 2.85 m available on request.

Includes 2 fittings on the cross piece for all-purpose trays; one spigot on one end of the beam onto which tilt heads or arms can be mounted; rotating pedal to lift/lower the stand.

For further technical data go to page 14

### Rotating pedal

This sophisticated mechanism allows the stand to be lowered onto the floor or raised onto its wheels with little effort.

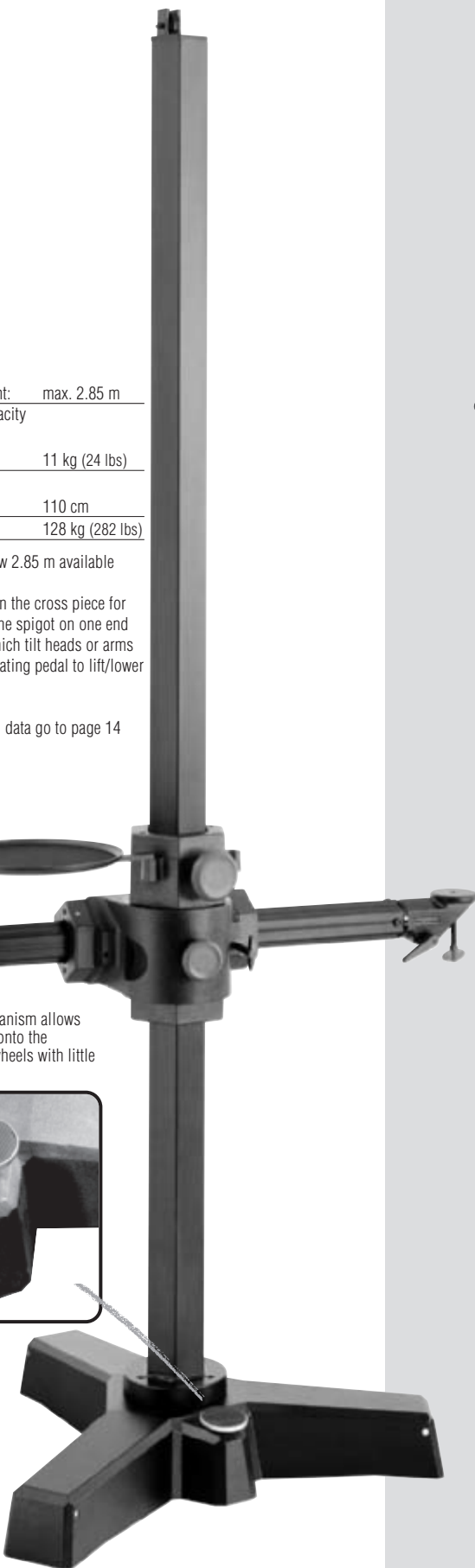
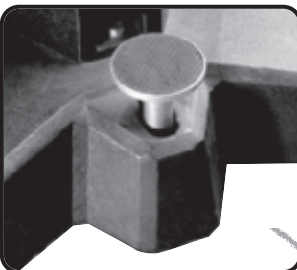

### AROB

Rotating platform, to be inserted onto the beam's spigot. 360° rotation and clamping. Spigot friction adjustable with two socket screws. Clamp can be mounted on both sides of the unit. Built-in rotation gauge on the spigot allows precise repetition of settings.

|                   |                  |
|-------------------|------------------|
| Camera thread:    | standard 3/8 "   |
| (on request 1/4") |                  |
| Weight:           | 1.3 kg (2.9 lbs) |



### ARBEO

Extended rotating platform, to be inserted onto the beam's spigot. The camera axis is lowered to correspond approximately to the beam axis.

This has two advantages:

- the rotating axis goes through the camera's gravity center, no matter how it is positioned, which simplifies the setting of the camera
- thanks to the low center of gravity, there is much less risk of the camera's toppling over when mounted in a wrong way.

360° rotation and clamping. Spigot friction adjustable with two socket screws. Clamp can be mounted on both sides of the unit.

|                   |                  |
|-------------------|------------------|
| Height variation: | 16 cm            |
| Camera thread:    | standard 3/8 "   |
| (on request 1/4") |                  |
| Weight:           | 1.8 kg (4.0 lbs) |

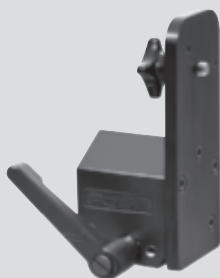

### ARBOE

Rotating upright, to be inserted onto the beam's spigot. The camera is screwed directly onto the upright and is thus perpendicular to the floor. This allows the studio stand to be used for photography reproduction. Two screws prevent the tipping of the camera.

Spigot friction adjustable with two socket screws; clamp can be mounted on both sides of the unit.

|                   |                  |
|-------------------|------------------|
| Camera thread:    | 3/8 "            |
| (on request 1/4") |                  |
| Weight:           | 1.1 kg (2.4 lbs) |



### ARBAO

Crank-operated rotating platform, to be inserted onto the beam's spigot. Self-locking, rotates even the heaviest equipment accurately and without effort. The crank handle can be installed on both sides for better and individual convenience. Built-in rotation gauge in degrees allows precise repetition of settings.

For other characteristics, see extended rotating platform ARBEO.

|                   |                |
|-------------------|----------------|
| Height variation: | 16 cm          |
| Camera thread:    | standard 3/8 " |
| (on request 1/4") |                |
| Tilt:             | 360°           |
| Weight:           | 4 kg (8.8 lbs) |



### ARBEA

Spigot extension, to be inserted onto the beam's spigot. Two clamping levers ensure great safety.

|                          |                  |
|--------------------------|------------------|
| Length (without spigot): | 60 cm            |
| Spigot's outer diameter: | 51 mm            |
| Weight:                  | 2.4 kg (5.3 lbs) |



### ASGUO

Additional counterweight, to be screwed on underneath existing standard counterweight. Increases the standard lifting capacity, e.g. for heavy cameras or sensors. Several counterweights can be added in the same manner.

|           |                 |
|-----------|-----------------|
| Diameter: | 8.6 cm          |
| Height:   | 12 cm           |
| Thread:   | M6              |
| Weight:   | 5 kg (11.0 lbs) |



### ARTEI

Lifting / lowering piece with own spigot, to be inserted onto the beam's spigot. For raising or lowering of equipment; usually mounted vertically.

Other platforms or extensions can be mounted on its own spigot. Spigot friction adjustable with two socket screws. Clamp can be mounted on both sides of the unit.

|                          |                  |
|--------------------------|------------------|
| Additional height:       | 35 cm            |
| Spigot's outer diameter: | 51 mm            |
| Weight:                  | 3.5 kg (7.7 lbs) |

## All-purpose middleweights

The successful all-purpose FOBA studio stand ASABA features the best price/quality ratio. It is ideally designed for 4x5", middle or digital professional cameras. The beam runs on ball bearings and is equipped on both ends with spigots, onto which any of the available rotating accessories can be inserted, thus enabling the photographer to install permanently the two cameras which are most often used. The vertical beam displacement is supported by a counterweight inside the shaft. With the addition of the ASOBU turning platform, the shaft can perform a full turn on its own axis. Ball bearing casters ensure smooth and comfortable floor displacements; stabilization through lowering and locking with rotating pedal.

### Versatile

A large selection of accessories turns each ASABA and ASABO studio stand into a unique and individual tool, specifically adapted for the task at hand.

#### ASABA

All-purpose studio stand, vertical and horizontal movements on ball bearings, lifting/lowering with rotating pedal. Top quality/price ratio. Custom height up to 3 m available on request (extra charge).

Standard floor height: 2,5 m

Lifting capacity  
(without additional counterweight): 9 kg (19.8 lbs)

Beam length:  
(without spigots) 100 cm

Weight: 96 kg (212 lbs)

Can be equipped with support for ARTEO / ARTEU on the crosspiece (extra charge).

For further technical data go to page 14

#### ASABO

Same as ASABA stand, except:

Standard floor height: 2.0 m

Weight: 92 kg (203 lbs)

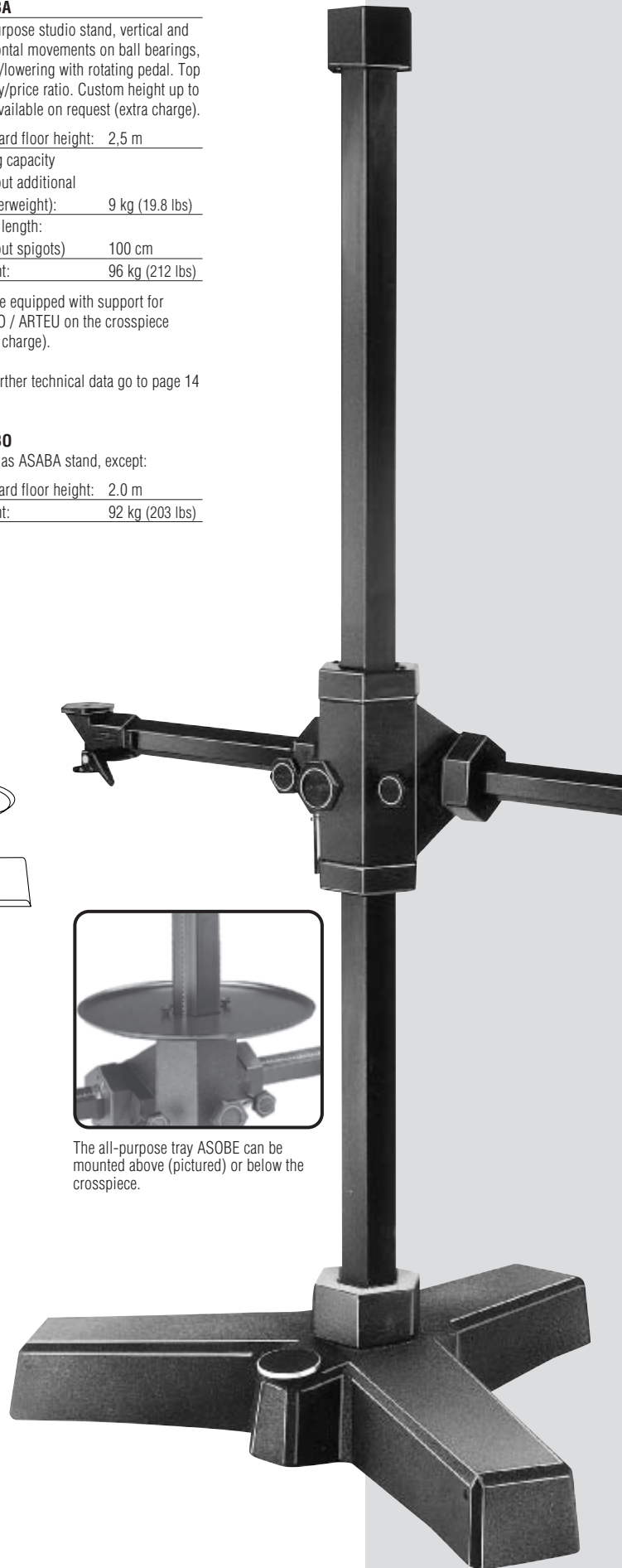
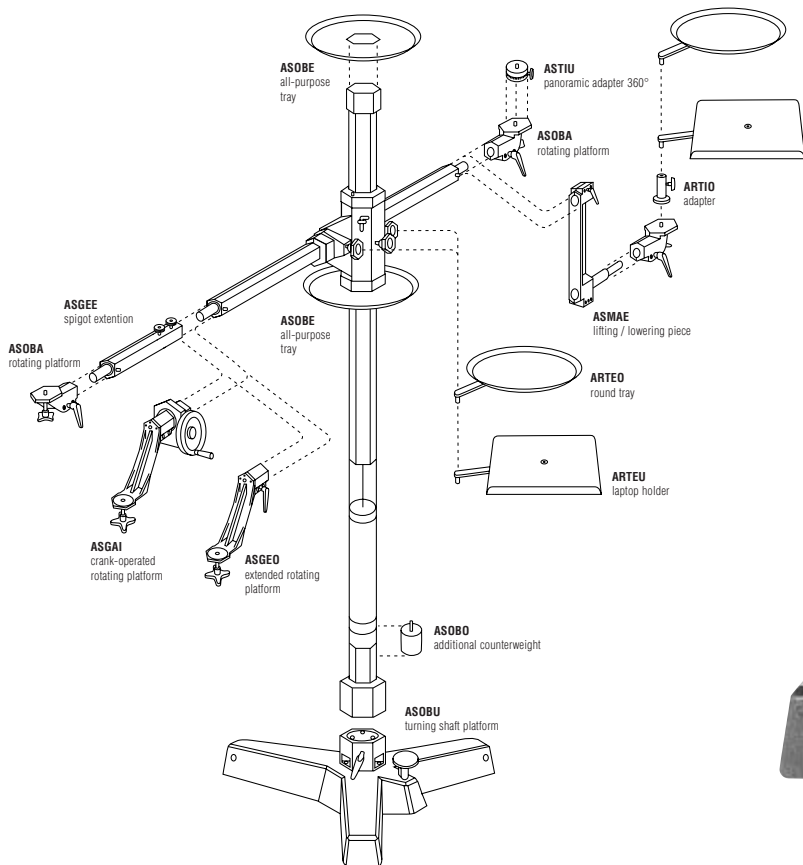

The all-purpose tray ASOBE can be mounted above (pictured) or below the crosspiece.

**ASABA**  
accessories at a glance



**ASOBA**  
Rotating platform, to be inserted onto the beam's spigot. 360° rotation and clamping. Spigot friction adjustable with two socket screws. Clamp can be mounted on both sides of the unit.

|                |                                  |
|----------------|----------------------------------|
| Camera thread: | standard 3/8 " (on request 1/4") |
| Weight:        | 760 g (1.7 lbs)                  |



**ASOBE**  
All-purpose round tray, inserted on the shaft above or below the crosspiece. To keep everything within hand's reach. Felt-covered aluminium.

|           |                  |
|-----------|------------------|
| Diameter: | 48 cm            |
| Weight:   | 1.3 kg (2.9 lbs) |



**ASOBO**  
Additional counterweight, to be screwed on underneath existing standard counterweight. Increases the standard lifting capacity, e.g. for heavy cameras or sensors. Several counterweights can be added in the same manner.

|           |                  |
|-----------|------------------|
| Diameter: | 7 cm             |
| Height:   | 6.6 cm           |
| Thread:   | M6               |
| Weight:   | 2.7 kg (6.0 lbs) |



**ASMAE**  
Lifting / lowering piece with own spigot, to be inserted onto the beam's spigot. For raising or lowering of equipment, generally used upright; other platforms or extensions can be mounted on its own spigot. Spigot friction adjustable with two socket screws. Clamp can be mounted on both sides of the unit.

|                          |                  |
|--------------------------|------------------|
| Additional height:       | 35 cm            |
| Spigot's outer diameter: | 41 mm            |
| Weight:                  | 2.4 kg (5.3 lbs) |



**ASGEO**  
Extended rotating platform, to be inserted onto the beam's spigot. The camera axis is lowered to correspond approximately to the beam axis. This has two advantages:  
- the rotating axis goes through the camera's gravity center, no matter how it is positioned, which simplifies the setting of the camera  
- thanks to the lower center of gravity, there is much less risk of the camera's toppling over when mounted in a wrong way. 360° rotation and clamping. Spigot friction adjustable with two socket screws. Clamp can be mounted on both sides of the unit.

|                   |                                  |
|-------------------|----------------------------------|
| Height variation: | 16 cm                            |
| Camera thread:    | standard 3/8 " (on request 1/4") |
| Weight:           | 1.5 kg (3.3 lbs)                 |

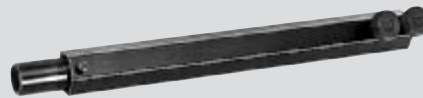

**ASGEE**  
Spigot extension, to be inserted onto the beam's spigot. Two clamping levers ensure great safety.

|                          |                  |
|--------------------------|------------------|
| Length: (without spigot) | 60 cm            |
| Spigot's outer diameter: | 41 mm            |
| Weight:                  | 1.2 kg (2.6 lbs) |



**ASGAI**  
Crank-operated rotating platform, to be inserted onto the beam's spigot. Self-locking, rotates even the heaviest equipment accurately and without effort. The crank handle can be installed on both sides for better and individual convenience. Built-in rotation gauge in degrees allows precise repetition of settings. For other characteristics, see extended rotating platform ASGEO. This unit is similar to ARBAO but fitted for the ASABA spigots.

|                   |                                  |
|-------------------|----------------------------------|
| Height variation: | 16 cm                            |
| Camera thread:    | standard 3/8 " (on request 1/4") |
| Tilt:             | 360°                             |
| Weight:           | 4 kg (8.8 lbs)                   |



**ASOBU**  
Turning shaft platform. Allows the shaft to rotate 360° on the cast-iron foot. Easy to install.

|         |                |
|---------|----------------|
| Height: | 10 cm          |
| Weight: | 14 kg (31 lbs) |

## DSS GAMMA (AROB)

### Best convenience for medium-size cameras

A sturdy cast-iron foot and accurate manufacturing means:  
Low weight – top stability.

#### Handy

DSS GAMMA stands are comparatively easy to dismount and reassemble, making them the ideal companions for out-of-studio applications.

#### Accurate

Rotating crosspiece with built-in rotation gauge in degrees. 24 ball bearings ensure smooth and easy movements (crosspiece vertically, beam horizontally). Easy and comfortable usage guaranteed.

#### Safe

The shaft is made of warp-resistant, hexagonal steel pipe. Both beam ends can be fitted with a camera or other equipment. The foot is equipped with a double pedal with which the entire stand can be lifted onto its wheels and rolled around, or lowered and stabilized on the ground.



Rotating crosspiece with built-in rotation gauge.



Double pedal to lift or lower the stand. Shock absorber available on request.

#### Technical data AROBI DSS GAMMA

|  |                            |
|--|----------------------------|
| Standard floor height:                                     | 2.0 m                      |
| custom length<br>(extra charge)                            | max. 2.7 m                 |
| Lifting capacity<br>(without additional<br>counterweight): | approx. 6 kg<br>(13.2 lbs) |
| Beam length: (including<br>camera platforms)               | 90 cm                      |
| Weight:  | 77 kg (170 lbs)            |

Graduated ruler built into shaft and beam, graduated gauge in degrees on the crosspiece.

Beam equipped with a platform for camera at each end, standard thread 3/8" (1/4" also available on request).

One fitting for all-purpose trays on the crosspiece.

Cast-iron foot with double pedal: optionally available: shock absorber ARBAU for smoother lifting and lowering.

The cast-iron foot for ASABA which has a greater weight available on request. (extra charge)

For further technical data go to page 14

#### Accessories at a glance:

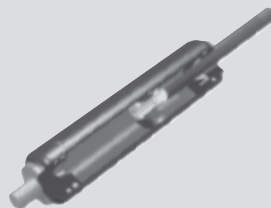

#### ARBAU / ARBAI

Optional shock absorber for AROBI's cast-iron foot. (ARBAU if ordered with the stand, ARBAI if ordered separately).

Weight: 340 g (0.75 lbs)



Laptop holder ARTEU, fits any current model.

It is possible to replace the standard beam with platforms by a beam equipped with a spigot at each end (extra charge option). This optional beam corresponds to the ASABA beam and allows all ASABA accessories (rotating platforms and arms) to be installed on the AROBI.



#### ARTEA

Additional counterweight, to be screwed underneath existing standard counterweight. Increases the standard lifting capacity, e.g. for heavy cameras or sensors.

Several counterweights can be added beneath one another in the same manner.

|           |                  |
|-----------|------------------|
| Diameter: | 6.1 cm           |
| Height:   | 6.6 cm           |
| Thread:   | M6               |
| Weight:   | 2.2 kg (4.9 lbs) |

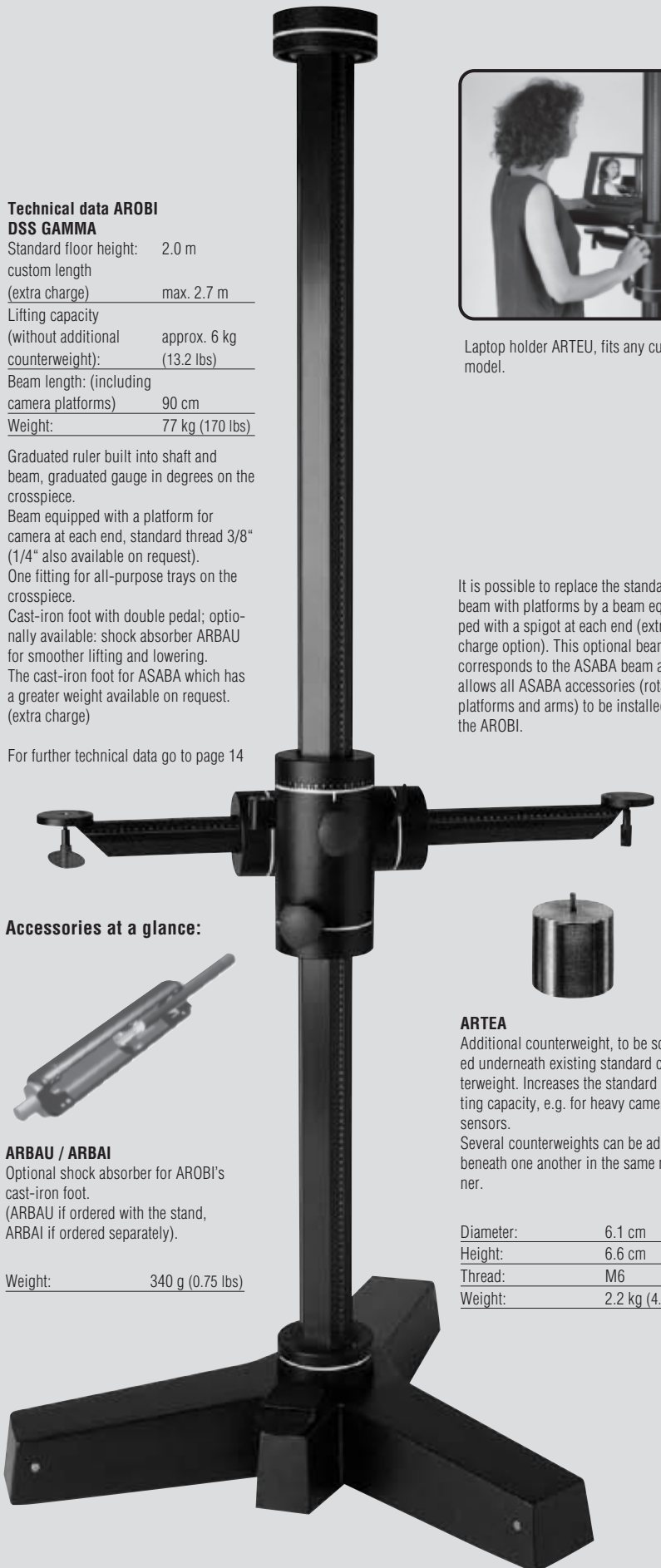

For further accessories go to page 13

www.foba.com



## ASLAI – great flexibility

### Easily movable

Portrait Pro ASLAI is designed to be moved around. The shaft can be unscrewed from the foot, which makes it easy to take along. Big ball bearing casters take even uneven floors and the occasional cables in their smooth stride. Therefore, ASLAI is the ideal companion for out-of-studio jobs.

### Steady

The shaft's low supporting point on the foot and the casters' easy to use, individual double lock mechanism result in high stability despite the reduced weight of the stand. High accuracy in production processes result in crosspieces and beams that can be locked in place without wobbling.



Rotating crosspiece.



Beam on ball bearing mechanism.



Ball bearing caster, with individual brake pedal. Wheel brake and swivel lock in one. Each caster can be locked separately.

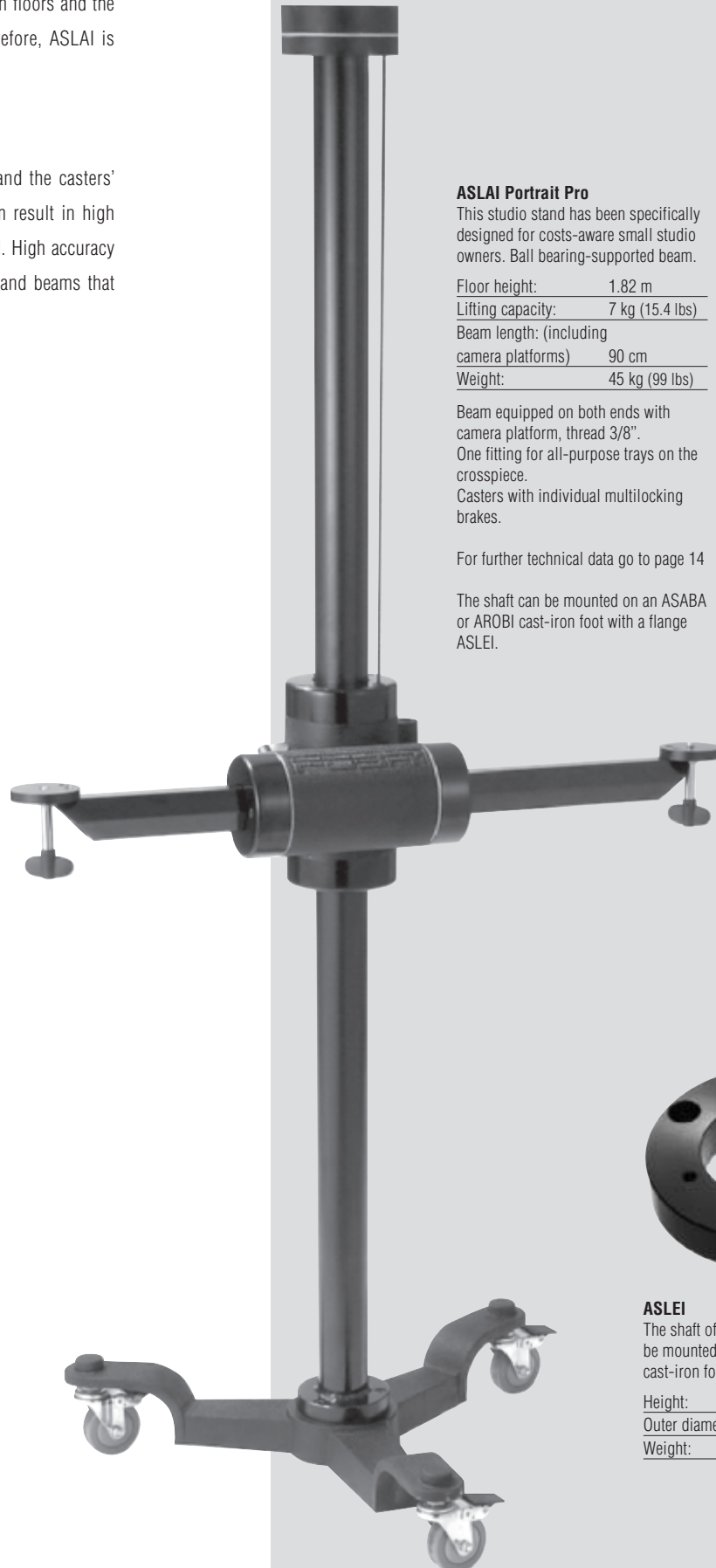

### ASLAI Portrait Pro

This studio stand has been specifically designed for costs-aware small studio owners. Ball bearing-supported beam.

|   |                 |
|---|-----------------|
| Floor height:                             | 1.82 m          |
| Lifting capacity:                         | 7 kg (15.4 lbs) |
| Beam length: (including camera platforms) | 90 cm           |
| Weight:                                   | 45 kg (99 lbs)  |

Beam equipped on both ends with camera platform, thread 3/8".

One fitting for all-purpose trays on the crosspiece.

Casters with individual multilocking brakes.

For further technical data go to page 14

The shaft can be mounted on an ASABA or AROBI cast-iron foot with a flange ASLEI.



### ASLEI

The shaft of the ASLAI studio stand can be mounted on an ASABA or AROBI cast-iron foot with this flange.

|                 |                    |
|-----------------|--------------------|
| Height:         | 27 mm              |
| Outer diameter: | 14 cm              |
| Weight:         | 0.740 kg (1.6 lbs) |

## Smart tripods

FOBA's reputation does not rest on its studio stands only. FOBA tripods have contributed to the company's renown for the past decades. FOBA tripods are designed to accompany the professional everywhere and satisfy his every requirement - the tougher the better. They are sturdy and reliable even under the heaviest cameras, easy and quick to set up, and enjoy an unmatched lifespan. But the top asset of FOBA tripods against competing products is their compatibility with the legendary COMBITUBE\* System components. Just screw on one or several of the sturdy COMBITUBE components onto the tripod's individual legs and any FOBA tripod can be installed even in the most uneven places. COMBITUBE brings such creativity and variation to FOBA tripods that other products can only dream of.

\* Visit [www.foba.com](http://www.foba.com) to learn more about the versatile COMBITUBE system

### ALFAE

Top Alu telescopic tubular tripod, can be extended almost at will by adding COMBITUBE\* components. Built-in bubble level. Three straddle positions, allowing a minimum height of 17 cm.

|   |                  |
|---|------------------|
| Max. standard height:   | 158 cm           |
| Maximum height variable with additional COMBITUBE components: |                  |
| Minimum height:   | 17 cm            |
| Length folded:  | 74 cm            |
| Camera thread:  | 3/8 "            |
| Max. load:  | 15 kg (33 lbs)   |
| Weight:   | 4.4 kg (9.7 lbs) |



### ALFEA

Crank-operated rod. Can be used as additional shaft on Top Alu ALFAE tripod to increase camera height by 30 cm. Functions as horizontally sliding beam on all other tripods. The self-locking rod is encased in a wedge-shaped guiding mechanism.

|                               |                  |
|-------------------------------|------------------|
| Additional height adjustment: | 30 cm            |
| Weight:                       | 2.3 kg (5.0 lbs) |





Always useful:  
removable rubber toe ASSME.



**ASGME**  
Steel point for tripod ALFAE / ASNIO,  
increases stability on any natural  
surface.

Weight: 60 g (0.13 lbs)



No limits!  
With COMBITUBE modular components.



**ASSME**  
Removable rubber toe to be inserted  
on the steel point ASGME. Prevents  
slipping and protects delicate floors.

Weight: 20 g (0.04 lbs)

With the COMBITUBE System, no obstacle is any longer insurmountable. If needed, the tripod legs can be mutually strutted with further COMBITUBE components for greater stability.



**ASNIO**  
With its 30 cm (folded length) this mini tripod is the world's smallest professional tripod equipped with FOBA's COMBITUBE\* System adapters. It can be installed anywhere: stairs, narrow corridors, places difficult to reach. With camera mountings threaded 3/8" and 1/4".

|                |                                    |
|----------------|------------------------------------|
| Height:        | variable with COMBITUBE components |
| Min. height:   | 10 cm                              |
| Folded length: | 30 cm                              |
| Max. load:     | 60 kg (132 lbs)                    |
| Weight:        | 2.1 kg (4.6 lbs)                   |



**ALFIA**  
The horizontal sliding rod is especially useful if a horizontal mobility is needed along with the vertical one. Can be mounted on any tripod or studio stand.

|                       |                  |
|-----------------------|------------------|
| Lateral displacement: | 42 cm            |
| Weight:               | 1.3 kg (2.9 lbs) |

Longer tube with up to 92 cm lateral displacement available on request. (extra charge)



The horizontal sliding rod ALFIA can be rotated 360° on the mounting clamp. Highly flexible shooting positions can be obtained in combining it with the panoramic adaptor ASTIU and the crank-operated rod ALFEA.

**Reprostand (REPRO)**

Reproduction stand, very sturdy and stable. The shaft in the typical FOBA hex steel pipe can support without problem the heaviest cameras. Beam and crosspiece are mounted on ball-bearings, all movements are smooth and almost effortless thanks to the counterweight inside the shaft. Cameras can be mounted on both sides of the beam. The REPRI wooden board is equipped with COMBITUBE\* fittings.

- Height: 150 cm
- Beam displacement: 23 cm
- Standard lifting capacity: 9 kg (19.8 lbs)
- Camera thread: 3/8" or 1/4"
- Weight: 37 kg (81.6 lbs)
- Optional accessories: set of additional counterweights REPRA.

Can be equipped with support for ARTEO / ARTEU trays on the crosspiece (extra charge)

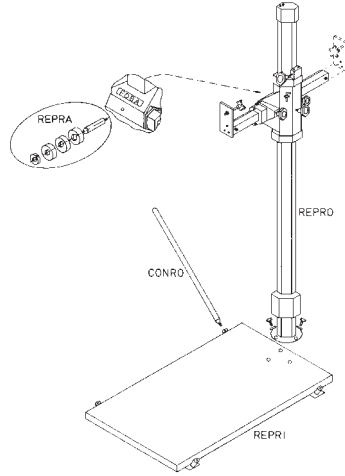
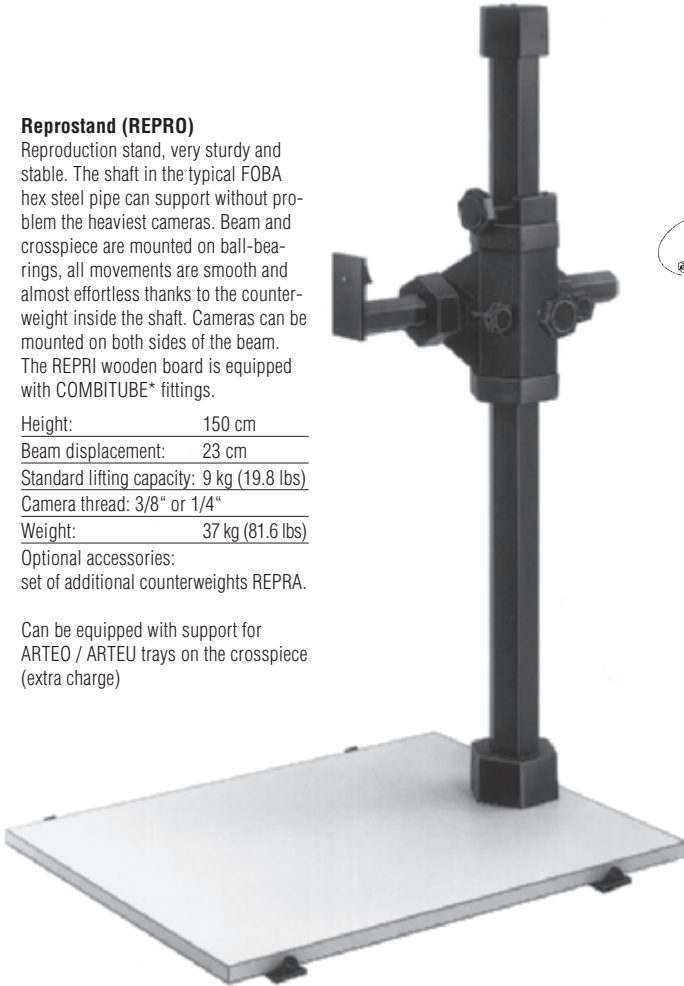

**REPRA**

Set of counterweights for all cameras, consisting of rod, 3 individual weights CEGOE and safety ring CEGEE 30. To counterbalance light-weight cameras.

|                           |                   |
|---------------------------|-------------------|
| Total weight:             | 6.5 kg (14.3 lbs) |
| Individual weights CEGOE: | 2 kg (4.4 lbs)    |

**REPRI**

Wooden board for reproduction stand REPRO, includes COMBITUBE\* adaptors (cone with 3/8" thread).

|             |                |
|-------------|----------------|
| Dimensions: | 70 x 110 cm    |
| Weight:     | 18 kg (40 lbs) |

\* Visit [www.foba.com](http://www.foba.com) to learn more about the versatile COMBITUBE system

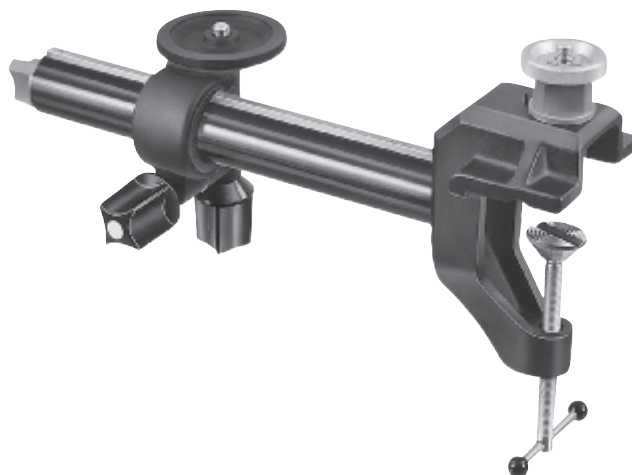

**ASNEO**

Clamp mounting for fixing cameras practically anywhere: on railings, ladders, window frames, tables, etc. This accessory is extremely useful for open-air photography in difficult situations where normal 3-legged tripods cannot be used. It is very stable, however strong the winds are. The ASNEA clamp and ASNAO camera mounting are also available separately.

The tube can be mounted on the clamping piece horizontally as well as vertically. It is available in different lengths.

|                          |                   |
|--------------------------|-------------------|
| Standard length of tube: | 30 cm             |
| Total weight:            | 1.45 kg (3.2 lbs) |



The clamp mounting ASNEO is so sturdy that even cameras with extended lenses can be fixed in a very stable way absolutely free of wobbling.

Made in Switzerland  
 Made by **FOBA**<sup>®</sup>

## Accessories for stands with hex pipe shafts

Tall stands (up to 6 m) can be delivered with the fittings MUBOD, MUDEK or MUWAN which fix it permanently to the floor instead of with the standard movable pedestal.



**MUDEK**  
**Ceiling attachment for column**  
 The holder is screwed onto the ceiling. To attach the stand below either a wall or floor attachment is necessary.



**MUWAN**  
**Wall attachment for column**  
 At least two wall attachments are necessary to attach the stand.



**MUBOD**  
**Floor attachment for column**  
 The holder is screwed onto the floor; the stand is then put over the cylinder. To attach the stand above either a wall or ceiling attachment is necessary.



Diameter of the column

|                |            |
|----------------|------------|
| AROB (ALPHA) / |            |
| AROBO (OMEGA): | d = 108 mm |
| ASABA:         | d = 80 mm  |
| AROBI (GAMMA): | d = 72 mm  |

[www.foba.com](http://www.foba.com)

## Common accessories for studio stands:



With adapter ARTIO, the trays ARTEO and ARTEU can be installed at the end of all stand beams.



**ARTEO**  
 Felt-lined round aluminium tray, to keep all kinds of small objects at hand.  
 Diameter: 35 cm  
 Weight: 0.8 kg (1.8 lbs)



Extremely practical for out-of-studio applications: the all-purpose trays can also be mounted on sturdy tripods such as the Top Alu ALFAE tripod from FOBA with the adapter ARTIO.



**ARTEU**  
 Aluminium laptop holder, for most lap-top formats. Tray swivels on supporting arm. Delivered with 4 adhesive Velcro pads

Width: 34 cm  
 Depth: 29 cm  
 Weight: 1.3 kg (2.9 lbs)



The adapter CEHUI allows the Laptop holder ARTEU to be combined with the COMBITUBE\* System. This is very practical for out-of-studio shootings.



**ARTIO**  
 Adapter for ARTEO and ARTEU trays, can be mounted on any rotating platform. Upper opening fitted for trays; lower opening with inner screw threaded 3/8" to be screwed on platform.

Height: 57 mm  
 Weight: 90 g (0.2 lbs)



**CEHUI**  
 Adapter for laptop holder; upper opening fitted for ARTEU; lower opening with inner screw cone threaded 3/8" for COMBITUBE.  
 Height: 48 mm  
 Outer diameter: 25 mm  
 Weight: 150 g (0.3 lbs)



**ASTIU**  
 Panoramic adaptor, swiveling range 360°. Includes interchangeable camera plate with 3/8" and 1/4" threads. Rotation gauge and lock screw.

Diameter: 76 mm  
 Height: 27 mm  
 Weight: 350 g (0.8 lbs)

\* Visit [www.foba.com](http://www.foba.com) to learn more about the versatile COMBITUBE system

## Summary – FOBA Studio Stands

|   | Large cameras or sensors<br>Great working height | Middlweight cameras or sensors   | ASABA   | Lightweight cameras or sensors<br>High mobility | ASLAI (Portrait Pro)        |
|---|--|----------------------------------|---|---|-----------------------------|
| <b>Characteristics</b>                                  | <b>AROB (DSS ALPHA)</b>                          | <b>AROB (DSS OMEGA)</b>          | <b>ASABA</b>  | <b>AROB (DSS GAMMA)</b>                         | <b>ASLAI (Portrait Pro)</b> |
| Standard floor height on casters                        | 2.7 m  | 2.85 m                           | 2.5 m (ASABA) / 2.0 m (ASABO)                               | 2.0 m   | 1.82 m                      |
| Optional height, on casters                             | custom up to 3.6 m or more                       | custom, max. 2.85 m              | custom, max. 3.0 m  | custom, max. 2.7 m                              | not available               |
| Immovable studio stand fixed with MUBOD, MUDEK or MUWAN | custom height up to 6.0 m                        | not available                    | custom height up to 5.5 m                                   | custom height up to 3.0 m                       | not available               |
| Weight, standard stand                                  | 201 kg (443 lbs)                                 | 128 kg (282 lbs)                 | 96 kg (212 lbs)   | 77 kg (170 lbs)                                 | 45 kg (99 lbs)              |
| Standard lifting capacity                               | 13 kg (28.5 lbs)                                 | 11 kg (24 lbs)                   | 9 kg (19.8 lbs)   | 6 kg (13.2 lbs)                                 | 7 kg (15.4 lbs)             |
| Additional counterweights                               | ASGUQ, 5 kg (11 lbs)                             | ASGUQ, 5 kg (11 lbs)             | ASOBO, 2.7 kg (6.0 lbs)                                     | ARTEA, 2.2 kg (4.9 lbs)                         | not available               |
| Vertical displacement<br>above floor at standard height | approx. 60 cm – 240 cm                           | approx. 50 cm – 250 cm           | approx. 45 cm – 230 cm<br>with ASOBU approx. 55 cm – 240 cm | approx. 40 cm – 180 cm                          | approx. 40 cm – 165 cm      |
| Swiveling shaft   | yes, on crosspiece                               | yes, on crosspiece               | yes, with optional turning<br>platform ASOBU                | yes, on crosspiece                              | yes, on crosspiece          |
| Beam length   | 110 cm (without spigots)                         | 110 cm (without spigot)          | 100 cm (without spigots)                                    | 90 cm (including platforms)                     | 90 cm (including platforms) |
| Horizontal beam displacement                            | 68 cm  | 68 cm                            | 64 cm   | 47 cm   | 47 cm                       |
| Max. shaft diameter                                     | 124 mm (hex pipe)                                | 124 mm (hex pipe)                | 91 mm (hex pipe)  | 82 mm (hex pipe)                                | 65 mm (pipe)                |
| Min. shaft diameter d                                   | 108 mm (hex pipe)                                | 108 mm (hex pipe)                | 80 mm (hex pipe)  | 72 mm (hex pipe)                                | 65 mm (pipe)                |
| Max. beam diameter<br>(hex pipe)                        | 82 mm  | 82 mm                            | 57 mm   | 57 mm   | 57 mm                       |
| Outer spigot diameter                                   | 51 mm  | 51 mm                            | 41 mm   | platform  | platform                    |
| Standard beam ends                                      | 2 spigots  | 1 spigot, optional second spigot | 2 spigots   | 2 platforms                                     | 2 platforms                 |
| Tray fitting(s)   | 4  | 2                                | 1 (optional)  | 1   | 1                           |
| Built-in ruler on shaft                                 | mm and inches                                    | optional                         | optional  | mm  | not available               |
| Built-in ruler on beam                                  | mm   | optional                         | optional  | mm  | not available               |
| Rotation gauge on beam                                  | 360° (1° sections)                               | optional                         | not available   | 360° (5° sections)                              | not available               |
| Rotation gauge on spigot                                | 360° (5° sections)                               | 360° (5° sections)               | not available   | no spigot                                       | no spigot                   |
| Pedal   | double   | rotating                         | rotating  | double  | individual caster lock      |
| Shock absorber  | yes  | no                               | no  | optional  | not available               |

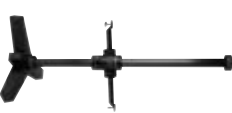

## FOBA studio stands and accessories

| Product | Description  | Page |
|---------|--|------|
| ALFAE   | Top Alu tubular tripod                             | 10   |
| ALFEA   | crank-operated rod for ALFAE                       | 10   |
| ALFIA   | sliding rod  | 11   |
| ARBAI   | separate hydr. shock absorber for AROBI            | 8    |
| ARBAO   | crank-operated rotating platform for AROBE / AROBO | 5    |
| ARBAU   | hydraulic shock absorber for AROBI                 | 8    |
| ARBEA   | spigot extension for AROBE / AROBO                 | 5    |
| ARBEO   | extended rotating platform for AROBE / AROBO       | 5    |
| ARBOE   | rotating upright for AROBE / AROBO                 | 5    |
| AROBA   | rotating platform for AROBE / AROBO                | 5    |
| AROBE   | DSS ALPHA studio stand                             | 4    |
| AROBE M | motorized DSS ALPHA studio stand                   | 2    |
| AROBI   | DSS GAMMA studio stand                             | 8    |
| AROBO   | DSS OMEGA studio stand                             | 5    |
| ARTEA   | additional counterweight for AROBI                 | 8    |
| ARTEI   | lifting / lowering piece for AROBE / AROBO         | 5    |
| ARTEO   | round tray   | 13   |
| ARTEU   | laptop holder                                      | 13   |
| ARTIO   | adapter for ARTEO / ARTEU                          | 13   |
| ASABA   | all-purpose studio stand 2.5 m                     | 6    |
| ASABO   | all-purpose studio stand 2.0 m                     | 6    |
| ASGAI   | crank-operated rotating platform for ASABA         | 7    |
| ASGEE   | spigot extension for ASABA                         | 7    |
| ASGEO   | extended rotating platform for ASABA               | 7    |
| ASGME   | steel point for tripods ALFAE / ASNIO              | 11   |
| ASGUO   | additional counterweight for AROBE / AROBO         | 5    |
| ASLAI   | PORTRAIT PRO studio stand                          | 9    |
| ASLEI   | Flange for ASLAI                                   | 9    |
| ASMAE   | lifting / lowering piece for ASABA                 | 7    |
| ASNEO   | Clamp mounting                                     | 12   |
| ASNIO   | mini tripod  | 11   |
| ASOBA   | rotating platform for ASABA                        | 7    |
| ASOBE   | all-purpose tray for ASABA                         | 7    |
| ASOBO   | additional counterweight for ASABA                 | 7    |
| ASOBU   | turning shaft platform for ASABA                   | 7    |
| ASSME   | removable rubber toe for ASGME                     | 11   |
| ASTIU   | panoramic adaptor 360°                             | 13   |
| CEHUI   | Adapter for laptop holder ARTEU                    | 13   |
| MUBOD   | Floor attachment for column                        | 13   |
| MUDEK   | Ceiling attachment for column                      | 13   |
| MUWAN   | Wall attachment for column                         | 13   |
| REPRO   | counterweights set for REPRO                       | 12   |
| REPRI   | wooden board for REPRO                             | 12   |
| REPRO   | reproduction stand                                 | 12   |



**FOBA®**  
STUDIO-TECHNOLOGY

- greater safety  
- greater mobility  
- greater stability

## FOBA quality for professionals

Stands and tripods have been FOBA's specialty for many years. State-of-the-art technology and finishing methods enable a degree of precision way beyond the customary values encountered in most studio stands. Even the largest and heaviest studio stands can be moved with minimum effort.

For the professional photographer, FOBA has more to offer than just stands and tripods. It provides a wide range of professional appliances. Beside FOBA's well-known, modular assembly system COMBITUBE, FOBA's name also stands for reliable and sturdy swiveling camera heads and complete studio set-up.

**FOBA studio stands – the reliable ones.**



## FOBA product lines

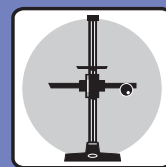

FOBA STUDIO STANDS, TRIPODS  
FOBA STATIVE  
FOBA PIEDS À COLONNE, TRÉPIEDS



FOBA TRIPOD HEADS  
FOBA STATIVKÖPFE  
FOBA TÊTES DE TRÉPIEDS

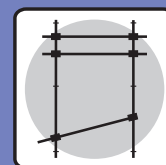

FOBA CEILING RAIL SYSTEM  
FOBA DECKENSCHIENEN-SYSTEM  
FOBA SYSTÈME RAILS DE PLAFOND

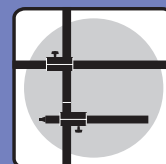

FOBA COMBITUBE SYSTEM  
FOBA COMBIROHR® SYSTEM  
FOBA SYSTÈME COMBITUBE



FOBA BACKGROUND TABLES  
FOBA AUFNAHMETISCHE  
FOBA TABLES DE PRISE DE VUE

**FOBA**<sup>®</sup>  
STUDIO-TECHNOLOGY

FOBA AG  
Studio-Technology  
Friedgrabenstrasse 21  
CH-8907 Wettswil  
☎ +41 44 701 90 00  
📠 +41 44 701 90 01  
✉ info@foba.com  
www.foba.com